

GUITAR

AND BASS LOUDSPEAKERS

CELESTION

The Voice of Rock & Roll



“

PARTNERS IN TONE
BILLY CORGAN

“On every stage I’ve ever walked on, in every studio I’ve ever worked in, there’s only been one speaker of choice to get THAT sound.”



CELESTION

GUITAR & BASS LOUDSPEAKERS

Ever since Vox slotted Celestion’s T.530—a “beefed-up” G12 general purpose radio speaker— into the AC15, and rock n’ roll jangled its way into Britain’s hearts back in the late 50s, the yin of amplifier power and the yang of sweet guitar speaker tone have been locked in constant battle.

We’re lucky though. Make a magnet bigger and you can change the tonal balance of a speaker as well as boosting its power rating. A voice coil former that’s better at repelling heat (a side-effect of more power) also gives us additional tonal qualities: percussiveness, more midrange character or if you want it, greater neutrality. Change the size of the coil for yet more tonal variation: make the thing sizzle, or make it dark and warm. Make the speaker a different size and, well, 10-inchers move faster and 15s may rumble like some deep baritone.

Sometimes I’m asked, “why so many speakers?”, but with so many variables at play there could be a whole lot more. As you thumb your way through this catalogue you’ll see it’s part history book as we trace the Celestion range through the years, and bear witness to all the favourites that have stood the test of time, as tastes and gear have changed. You’ll also see there are plenty of newer models too (we’ve launched six this past three years alone) all born from the white heat of that battle between power and tone.

And these days, gear really is changing. Now amp modelling and profiling, DAWs and plug-ins have taken music-making firmly into the digital domain, so the tone has followed. For Celestion, this manifests itself in the form of impulse responses: stunningly accurate, downloadable versions of Celestion speakers that are as portable as your digital rig with the accuracy, flexibility and repeatability that this technology so effortlessly provides. Available as well as or instead of the original speakers that made it all possible. In the end, the tone always wins.

Dr. Decibel. Ipswich, December 2019.

THE LOUDSPEAKERS

Ruby, Blue, Cream, Gold, G10 Gold.....	Pages 4-5
G12M Greenback, G12H Anniversary, G10 Greenback, EVH Signature	Pages 6-7
G12M-65 Creamback, G12H-75 Creamback, Neo Creamback, G10 Creamback	Pages 8-9
Vintage 30, G12-65, Classic Lead 80, G10 Vintage.....	Pages 10-11
Neo 250 Copperback, G12T-75, G12K-100, G12H-150 Redback.....	Pages 12-13
A-Type, VT Junior, V-Type, G15V-100 Fullback	Pages 14-15
Midnight 60, Eight 15, Ten 30, Seventy 80	Pages 16-17
Impulse Response, F12-X200	Pages 18-19
PULSE 10, PULSE 12, PULSE 15	Pages 20-21
BL10-100X, BN10-200X, BN10-300X	Pages 22-23
BN12-300S, BL15-300X, BN15-300X, BN15-400X	Pages 24-25
Guitar Loudspeaker Specifications & Frequency Response Graphs	Pages 26-29
Bass Loudspeaker Specifications & Frequency Response Graphs	Pages 30-31
Chassis Drawings	Pages 32-33
F12-X200 Cabinet Build Instructions	Page 34

ALNICO

From the 60s to the present day, the unmistakable sound of the Celestion Alnico magnet guitar speaker with its trademark laid back attack continues to shape popular music. Back then, we answered the call from our friends at Vox and Marshall for a dedicated guitar loudspeaker which became the now-famous 'Blue'. That speaker has gone on to inspire a complete range of speakers designed to deliver the much-loved Celestion Alnico character with a variety of tonal flavours and power ratings.

RUBY

12" 305mm 1 3/4" Voice Coil 35 Watts 8/16 Ohm 100 dB

Bringing the instantly familiar, broken-in Celestion alnico vibe, the Ruby is arguably recognised as the warmest of the Celestion Alnicos, oozing a richly musical vintage warmth, with mellow highs and a smooth, vintage midrange. And at 35-watts power handling, it's ideal for use with mid-powered amps and combos.

“

PARTNERS IN TONE
BRIAN MAY

“Nothing else sounds like a Celestion Blue.”



BLUE

12" 305mm 1 3/4" Voice Coil 15 Watts 8/15 Ohm 100 dB

The legendary Blue is widely acknowledged as the benchmark for guitar speaker perfection. Noted for its high-frequency brilliance and sparkle, the upper mids sing, the low mids are slightly scooped and the bass perfectly rounded. It's a speaker that evokes rich definition, developing a beautiful, musical compression when pushed.



GOLD

12" 305mm 1 3/4" Voice Coil 50 Watts 8/15 Ohm 100 dB

Bringing a modern edge to the Celestion Alnico range, the Gold is defined by softer high-frequencies with a more defined upper-mid vocal character. With strong projection in the lows and low-mids, the Gold is recognised as the punchiest of the Alnicos, perfect for huge rhythm voicings and saturated vocal lead tones.

“

PARTNERS IN TONE
BRAD PAISLEY

“With the Gold, Celestion has nailed the tone of the original Blue in a higher watt speaker. The Celestion Blue sound has always been a big part of my tone.”



CREAM

12" 305mm 1 3/4" Voice Coil 90 Watts 8/16 Ohm 100 dB

For amps from 1-watt to 90-watt, the superbly balanced Cream combines power handling capability with a seemingly never-ending supply of Alnico tone. It has quickly earned a reputation for smooth, sophisticated mids, further characterised by a fine-grained detail that adds a high-definition quality to the speaker's vocal range, yielding more expressiveness than you ever thought possible.



G10 GOLD

10" 254mm 1 3/4" Voice Coil 40 Watts 8/15 Ohm 98 dB

The mellowness of the original Blue, with the speed and response of a 10" driver. The G10 Gold blends unmistakable Alnico class with a rich low-end, creamy mid-range and vintage chiming top-end. It is springy, warm, revealing and highly expressive adding a classy sheen to any amp with depth and shimmer.



GREENBACK

As the blues gave birth to hard rock, Celestion Greenbacks proved to be the right tone at the right time. Offering a higher power rating than Alnico speakers, the G12M and G12H with its ceramic magnet and responsive feel was a perfect complement to players who were driving their amps harder and harder. The speakers that gave us Clapton's 'Bluesbreaker' tone on All Your Love and the sonic bombast of Hendrix's Star Spangled Banner at Woodstock, remain the benchmark by which all others are measured.

G12M GREENBACK

12" 305mm 1 3/4" Voice Coil 25 Watts 8/16 Ohm 98 dB

The G12M Greenback has evolved over the decades but still retains its essential, sought-after tone. This model is voiced with additional broad mid-range attack and restrained top-end to give a forward, punchy attitude to chords and a searing lead tone without fizz. With its well-controlled low-end it can be used singly in low-powered amps, or in multiples for high-power rock heads, bringing drive and definition to modern high gain amps.

“

PARTNERS IN TONE
TONY IOMMI

“Celestion is the voice of rock. Always has been. Always will be.”



G12H ANNIVERSARY

12" 305mm 1 3/4" Voice Coil 30 Watts 8/16 Ohm 100 dB

With a strong, aggressive low-end and powerful low-mids, the G12H penetrates any mix with an attacking upper mid-range and an ice-cool top-end. Used singly or in quartets it provides serious attitude and swagger to soft amp tones, easily cutting through loud stage levels for chord work, and imparting a hard edge to single notes.



G12EVH EDDIE VAN HALEN SIGNATURE SPEAKER

12" 305mm 1 3/4" Voice Coil 20 Watts 8/15 Ohm 96 dB

In the studio or on the stage, the Celestion 20-watt 'Greenback' has played an essential role to Edward Van Halen in making the tones that rewrote the book on guitar sound. With the addition of a black rear can featuring the EVH logo and his unmistakable red, white and black stripes, the G12EVH was born. Unmistakable look but, more importantly, unmistakable tone.

“

EVH™ and the EVH™ logo are the registered trademark of E.L.V.H. Inc. The unique striped design is a copyright (2001) of E.L.V.H. Inc. All rights reserved.

“Since Day One, Celestion speakers have been a big part of my sound.”

G10 GREENBACK

10" 254mm 1 3/4" Voice Coil 30 Watts 8/16 Ohm 95 dB

Recapturing the legendary sound of Celestion's 10-inch speakers from the 1970s, the G10 Greenback delivers a surprisingly meaty tone. Low in output but with the weighty low-end balance of a 12", it features a complex mid-range and smooth, vintage top-end. In small combos this speaker adds real class, and in a 4x10 gives rise to a raunchy, full-bodied tone, rich in low-end thump.



CREAMBACK

The ever-popular Greenback is the undisputed reference point for sweet, harmonically rich tone and also for the way in which the output of an amplifier should be articulated as it tips from clean to crunch and through to fully-saturated overdrive. But what if you need Greenback sonics and response with more than 30-Watts power handling? Enter the Creambacks.

G12M-65 CREAMBACK

12" 305mm 1 3/4" Voice Coil 65 Watts 8/16 Ohm 97 dB

Bringing vintage tone to modern-day amps, the G12M-65 Creamback delivers the familiar, woody tone of the G12M Greenback along with greater power handling. This brings with it low end grunt complementing the warm and vocal mid range, crunchy upper-mids and sweet, refined highs.

“

PARTNERS IN TONE JOE PERRY

“They are beyond the mechanical fact that they are speakers. They’re iconic and the name Celestion literally puts you in another zone... they always have for me.”



G12H-75 CREAMBACK

12" 305mm 1 3/4" Voice Coil 75 Watts 8/16 Ohm 100 dB

The G12H-75 Creamback provides 75-watts of power handling and unmistakable G12H tone, with a tighter low end than the G12M-65 Creamback, and a punchier, more dynamic high end. The H magnet brings additional focus, body and girth to the Creamback tone, thickening single notes for a highly articulate, vocal character.



G10 CREAMBACK

10" 254mm 1 3/4" Voice Coil 45 Watts 8/16 Ohm 96 dB

Everything guitarists love about Celestion Creambacks, wrapped up in a 10-inch package. Warm, expressive, detailed and well-balanced, this speaker performs beautifully in singles, pairs or 4x10 configurations.

“

PARTNERS IN TONE KENNY WAYNE SHEPHERD

“When I wanted a speaker that’s road worthy, studio ready, and has that fat vintage tone, I went to the company that makes music history. Celestion.”



NEO CREAMBACK

12" 305mm 1 3/4" Voice Coil 60 Watts 8/16 Ohm 97 dB

Every ounce a Classic Celestion, the Neo Creamback delivers all the magical tone you'd get from a conventional Creamback at around half the weight of a traditional speaker, thanks to its Neodymium magnet. Expect the same low end punch, warm, vocal midrange and sweet highs that made the Creamback famous: push it hard and enjoy the 'race-car growl' that sets pulses racing.



FOREVER CELESTION

As the blues-infused 70s gave way to the harder rocking 80s, the only thing higher than the guitar amp gain was the hairstyles. And so a new range of speakers evolved, capable of articulating the complex, overdriven sounds and blistering lead lines of the time, with the ability to handle increasingly high amplifier outputs.

VINTAGE 30

- 12" 305mm
- 1 3/4" Voice Coil
- 60 Watts
- 8/16 Ohm
- 100 dB

Back in 1986 we combined an 'H' magnet (the closest in performance to Alnico) with a new cone and voice coil employing contemporary materials to create our most revealing speaker, the Vintage 30. This legend features enormously detailed and complex overtones, a warm low-end, a famously rich vocal mid-range and a beautifully detailed top-end. It reveals the complexities in hand-wired boutique amps, and exhibits a wonderfully intricate vintage three dimensional crunch.



“

PARTNERS IN TONE SLASH

“I’ve been using Celestion Vintage 30 speakers my whole career and can’t imagine using anything else.”



G12-65

- 12" 305mm
- 1 3/4" Voice Coil
- 65 Watts
- 8/15 Ohm
- 97 dB

With its fast attack and tightly controlled low-end, the G12-65 became a firm favourite with hard rock players by the early 80s, particularly in 4x12s. And still today, the precisely tuned mid-range and crisp defined top-end contribute to an aggressive crunch sound that punches through the mix while the mid-range warmth and detail give weight and depth to single notes.

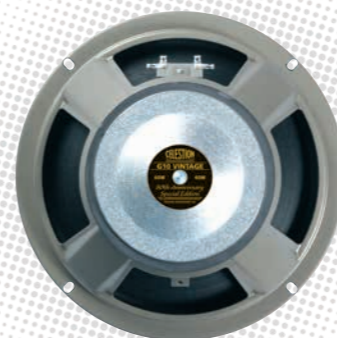

G10 VINTAGE

- 10" 254mm
- 1 3/4" Voice Coil
- 60 Watts
- 8/16 Ohm
- 99 dB

With the fast response of a 10" but with the strong and creamy vocal tones of a 12", the G10 packs an impressive punch and is the ideal choice to add depth to hollow-sounding amps, or for players who want to get humbucker-type girth from single-coils. Can be used singly to add vocal warmth to small valve combos, or in quartets for a weightier but still lively attack.

“

PARTNERS IN TONE STEVE VAI

“Celestion speakers speak honestly and clearly. They enable me to hear what I’m thinking.”



CLASSIC LEAD 80

- 12" 305mm
- 1 3/4" Voice Coil
- 80 Watts
- 8/16 Ohm
- 99 dB

A natural evolution of the G12-80 and a firm favourite with lead guitarists, the Classic Lead uses a fibreglass voice coil former to deliver an 80W power rating and a unique dynamic sound. With a tightly controlled low-end, strong high bass / low mid punch, aggressive mid range attack and a powerful yet controlled top-end, power chords make their presence felt while the subtle high-frequency roll-off makes this speaker ideal for solos.





PARTNERS IN TONE
JOE SATRIANI
plays G12T-75

POWER AND TONE

Fashions in guitar amplification are constantly evolving. The current desire for increased portability calls for loudspeakers that deliver greater power handling or reduced weight, and sometimes both. But it's reassuring to know that whatever the size of your cab or the output of your amp, you'll never have to choose between power and tone.

NEO COPPERBACK

- 12" 305mm
- 2 1/2" Voice Coil
- 250 Watts
- 4/8/16 Ohm
- 100 dB

Rated at 250-watts but weighing in at just 5lbs/2.3Kgs, the highly-musical Neo 250 Copperback supplies tons of tone. For players who prefer more transparency and less midrange vocal intensity, this Neodymium-magnet speaker reveals the best from your amplifier and playing without additional colouration. The speaker's unique response has a tight low end, neutral low mids, a clear, open upper-mid definition and well-controlled high treble, providing unparalleled dynamics and all the headroom and touch sensitivity you could possibly need.



G12T-75

- 12" 305mm
- 1 3/4" Voice Coil
- 75 Watts
- 8/16 Ohm
- 97 dB

Featured in the world's top selling 4x12 cabinet, the G12T-75 combines a huge, tightly controlled low-end and aggressive mid-range with a softened top-end that adds a welcome sweetness to overdrive, distortion and aggressive upper harmonics. A high powered rock player's dream come true.



G12K-100

- 12" 305mm
- 1 3/4" Voice Coil
- 100 Watts
- 8 Ohm
- 99 dB

Celestion's very own monster of rock, the G12K-100 makes full use of the heaviest G12 magnet to combine huge power handling with superb clarity across a wide frequency response. A massive bottom-end, rock-hard mid-range and restrained top-end make this the perfect speaker to add thump and grind to modern high-gain tones.



G12H-150 REDBACK

- 12" 305mm
- 2" Voice Coil
- 150 Watts
- 8/16 Ohm
- 100 dB

Designed for extreme power handling without compromising tone, the G12H-150 Redback delivers balance, responsiveness and superb playability, all with muscular ease. With a tight, well-controlled low end, detailed midrange and more relaxed treble, expect tons of smooth, clean tone in pedal/combo configurations, or simply hook one up to your 100-watt head for giant slabs of tone.



PARTNERS IN TONE **KERRY KING**

plays G12K-100





ACCESS ALL AREAS

For ambitious players looking for bold, original tones to break new sonic ground, these innovative speakers look to the future, providing new tonal flavours for guitarists seeking out their signature sound.



A-TYPE

- 12" 305mm
- 1 3/4" Voice Coil
- 50 Watts
- 8/16 Ohm
- 98 dB

Inspired by our favourite modern American tones, the A-Type is a different kind of guitar speaker from Celestion. Of course, it still has the musical and revealing three-dimensional quality that is the heart and soul of a Celestion guitar speaker, however it features a more laid-back midrange which reveals body and complexity in the upper register, accompanied by full and rounded low frequencies.

“

PARTNERS IN TONE RICHARD FORTUS

“Celestion is as integral a part of my sound as my guitars and amps and I won’t play anything but the best!”



VT JUNIOR

- 10" 254mm
- 1 3/4" Voice Coil
- 50 Watts
- 8/16 Ohm
- 95 dB

Delivering the same balance and musicality as its big brother the V-Type, the VT junior brings all the speed and response you’d expect from a 10, along with an additional low mid punch and high end sparkle.



G15V-100 FULLBACK

- 15" 381mm
- 2" Voice Coil
- 100 Watts
- 8/16 Ohm
- 99 dB

Retaining Celestion’s classic, harmonically complex and finely detailed mid-range, the larger cone of the Fullback shifts this characteristic down a register. Clean sounds are warm and expressive, revealing and enhancing the qualities of your amp and guitar without unnecessary colouration. Overdrive sounds are complex and musical; push harder for a weighty, contralto growl, with a softer, warmer mid-range.

“

PARTNERS IN TONE STEFFEN KEMMERER

“When I first heard a 412 cabinet loaded with A-Type/ V-Type Celestions, I couldn’t believe my ears.”



V-TYPE

- 12" 305mm
- 1 3/4" Voice Coil
- 70 Watts
- 8/16 Ohm
- 98 dB

The V-Type delivers authentic Celestion tone together with vintage musicality and a thrilling, tactile responsiveness that leaves you feeling connected to the music and makes you want to keep on playing. Cleans are true across the lows, mids and highs, with just enough upper-mid chime and HF sparkle to add clarity and definition. Or crank it up for a sizzling overdrive and raw rock tones, with plenty of midband warmth to give body and substance to lead note playing.





ORIGINALS

As the original name in guitar loudspeakers, we're dedicated to delivering great tone regardless of genre, playing style or budget. Nobody knows more than us about designing and manufacturing guitar speakers and the Celestion Originals are proof of that. This range is built to exacting standards for consistently high quality and reliability, delivering Celestion tone and performance in some of the world's best-selling amps and cabs.

MIDNIGHT 60

- 12" 305mm
- 1 3/4" Voice Coil
- 60 Watts
- 8/16 Ohm
- 96 dB

The Midnight 60 continues Celestion's tradition of delivering rich, classic British tone in innovative new ways, featuring the moving parts that were inspired by the V-Type design, but with a different magnet assembly which has the effect of shifting the tonal balance to give a sonic character more reminiscent of Celestion's vintage G12L speaker.

Whatever the genre, Midnight 60 provides an exhilarating sound in the classic Celestion style. Cleans are well-balanced with just enough top end to make the high frequencies sparkle. Overdriven this speaker brings searing rock tones, with plenty of low-end warmth and mid-band character.

“

PARTNERS IN TONE WAYNE SERMON

“With all the different amp and cab sizes I use, Celestion always has a speaker that does what I need it to do.”



TEN 30

- 10" 254mm
- 1 1/4" Voice Coil
- 30 Watts
- 8/16 Ohm
- 95 dB

Rich and expressive, the Ten 30 combines warm lows with a vocal mid-range and an articulate top end. The clean sound is open and revealing; push hard and you're rewarded with full-blooded Celestion grind.



SEVENTY 80

- 12" 305mm
- 1 3/4" Voice Coil
- 80 Watts
- 8/16 Ohm
- 98 dB

Conceived in the late '90s as the G12P-80, the Celestion Seventy 80 has become one of the most widespread guitar speakers we've ever produced, finding its way into an extensive range of amps and cabs. Delivering a detailed and crisply defined tone, the Seventy 80 has a tightly controlled low-end with a punchy, aggressive upper mid-range. The top-end response is glassy and clear for enhanced treble and a full-range feel without compromising its undeniable Celestion character.

“

PARTNERS IN TONE RICK NIELSEN

“Celestion. Why bother with anything else?”



EIGHT 15

- 8" 203mm
- 1" Voice Coil
- 20 Watts
- 4/8/16 Ohm
- 95 dB

The Eight 15 is ideal for upgrading your bedroom blaster with authentic British tone. Well-balanced mids and highs complement a surprisingly meaty bottom end - it's just about the biggest sounding eight inch speaker we've ever heard! And there's also a 4Ω version, making it ready, willing and able to blast new life into junior combos like the Fender® Champ.



IMPULSE RESPONSES

Authentic Celestion Tones in Digital Format



Nobody knows more about guitar speaker tone than Celestion. So who better than Celestion to bring you stunning combinations of speakers, microphones and their placements in a range of Impulse Response digital downloads. Captured by award-winning recording engineers in world-class facilities using state-of-the-art recording equipment, Celestion IRs empower you to escape the limitations of a single mic and cabinet setup and explore a universe of possibilities to create your own perfect tone. And once you've found it, you'll be able to recreate it precisely, anytime, anywhere – at home or on the road.

For more information visit celestionplus.com



CELESTION
DIGITAL DOWNLOAD

“

PARTNERS IN TONE
JEFF STINCO

“The IRs are absolutely stunning. I now use them live on all my sounds.”



F12-X200

12"
305mm

2"
Voice Coil

200
Watts

8
Ohm

97
dB

The lighter moving mass and straighter sided cone of the type commonly used with guitar speakers gives the X200 the feel and live response of a traditional guitar speaker, delivering all the physical feedback you'd expect from playing through a conventional guitar rig.

“

PARTNERS IN TONE
STEVE STEVENS

“The Celestion IRs make a laughing stock of the other ones out there. Finally...done right. Couldn't be more impressed!”

FINALLY, A DEDICATED GUITAR SPEAKER FOR AMP MODELLERS AND IRs

FULL RANGE | LIVE RESPONSE

The world's first dedicated guitar loudspeaker for use with amp modellers and IRs, the F12-X200 is a truly full range driver that delivers a frequency response from 60Hz all the way up to 20kHz.

With the high frequencies reproduced by an integrated Celestion compression driver, the F12-X200 delivers the full spectrum of audible frequencies for the most accurate output possible, whatever your environment and set-up. Its response is remarkably neutral, with Celestion technology built in to ensure there are no unwanted colourations that can overpower the input signal.

Check out page 34 for our recommended F12-X200 1x12 cabinet design.





PULSE BASS SPEAKERS

For those that bring rumble and thunder, Celestion has created PULSE – a range of three powerful, dependable, ferrite magnet bass speakers built to deliver your sound with all the punch and clarity you need to hold down the bottom end in any musical situation. Rigid steel frames ensure maximum energy transfer, highly responsive Kevlar-loaded cones enhance the dynamics, extra-long voice coils extend ‘throw’ and multi-roll surrounds increase bass response.

“

**PARTNERS IN TONE
REX BROWN**
“I’m literally blown
away by these speakers!
Thunder!!”



PULSE 10

10" 254mm	Ferrite	200 Watts	8 Ohm	94 dB
--------------	---------	--------------	----------	----------

With its robust steel-chassis, PULSE 10, provides a rock-solid bass performance whether alone in a single speaker combo, in a 4x10 or even an 8x10 cab. Expect a tight, punchy low end with a warm mid-range that’s full of presence, bringing focus and articulation to your playing. This heavy-duty driver truly delivers bass you can feel as well as hear.



PULSE 15

15" 381mm	Ferrite	400 Watts	8 Ohm	96 dB
--------------	---------	--------------	----------	----------

With a longer voice coil for increased ‘throw’ and a multi-roll surround that provides exceptional linearity and superb bass extension, the 400-watt PULSE 15 is impeccably-designed sonic artillery. Featuring a Kevlar loaded cone and rigid steel chassis designed for maximum energy transfer, this robust and reliable speaker truly is a powerhouse of deep bass tone.

“

PARTNERS IN TONE RICKY PHILIPS

“I experimented with many different amp heads, but I realized the unchangeable constant was a cabinet filled with Celestion speakers.”



PULSE 12

12" 305mm	Ferrite	200 Watts	8 Ohm	94 dB
--------------	---------	--------------	----------	----------

For bass players demanding well-defined clarity and stunning articulation together with a rich, full tone, PULSE 12 bass speakers deliver an ideal combination of responsiveness and rock solid low end. The Kevlar-loaded cone pulses with up to 200 watts of raw bass power. Expect each note to deliver a thick, percussive attack along with the mid-range necessary to break through in any performance situation.





PARTNERS IN TONE
TROY SANDERS
plays BL10-100X

BASS SPEAKERS

Expect a potent combination of technology and tone from Celestion bass speakers, built to deliver the exceptional performance demanded by modern amplifiers, while meeting the sonic demands of a wide range of players and playing styles. With a choice of 10", 12" and 15" chassis sizes, impedances and magnet types, the Celestion Bass Speaker range provides amp builders and players looking to upgrade their rigs with a comprehensive range of options.



BL10-100X

10" 254mm	Ferrite	100 Watts	8 Ohm	94 dB
--------------	---------	--------------	----------	----------

Built for bass without compromise, the 100-watt BL10-100X delivers heavy duty presence with drive, clarity and a full-bodied tone. Fast and articulate, this dependable performer brings clarity and definition to every note.



BN10-200X

10" 254mm	Neo	200 Watts	8 Ohm	96 dB
--------------	-----	--------------	----------	----------

Expression and musicality come as standard with the 200-watt BN10-200X. Light in weight but not certainly not in performance, this neodymium magnet bass speaker delivers a rich warm tone combined with a powerful low end punch.



BN10-300X

10" 254mm	Neo	300 Watts	4 Ohm	96 dB
--------------	-----	--------------	----------	----------

Delivering superb low end projection and a detailed mid-range that only an advanced Celestion neodymium motor could be capable of. Available exclusively in 4Ω, the BN10-300X is an excellent and very lightweight tone machine.

“

PARTNERS IN TONE CESAR CHANONA

“In my 20 years of playing only Celestion has given me all of the bass, definition and power I need to sound my best.”



BASS SPEAKERS

PARTNERS IN TONE
TOMMY STINSON

“I’m loving these
15-inch Celestions.
They work great!”



Deploying Neo-magnet ‘BN’ speakers can dramatically reduce the weight of a bass cabinet or combo – a welcome development for any hard-working bass player – while the availability of 4Ω and 8Ω impedance options provides flexibility for configuring single or multiple driver cabinets. And it all comes with legendary Celestion performance and dependability, delivering the bottom line night after night.



BL15-300X

15" 381mm	Ferrite	300 Watts	4 Ohm	96 dB
--------------	---------	--------------	----------	----------

This 15" steel bass speaker has industry leading engineering built in, together with signature Celestion tone that you can feel with every single note.



BN15-300X

15" 381mm	Neo	300 Watts	4 Ohm	96 dB
--------------	-----	--------------	----------	----------

BN15-300X has a lightweight magnet for increased portability and is purpose-built to provide 300-watt power handling and a rich, warm bass tone.



BN15-400X

15" 381mm	Neo	400 Watts	8 Ohm	95 dB
--------------	-----	--------------	----------	----------

With 400-watt of thunderous power handling capability, the lightweight neodymium magnet BN15-400X skilfully brings your low end to the forefront.



BN12-300S

12" 305mm	Neo	300 Watts	4/8 Ohm	99 dB
--------------	-----	--------------	------------	----------

12-inch bass speakers deliver an ideal combination of responsiveness and rock solid low end. This highly efficient, lightweight neodymium speaker is a strong performer whatever your rhythmic style. The BN12-300S delivers clear, well-balanced bass so you will be confident in your performance whether holding the line or punching through the mix.



PARTNERS IN TONE
ADEN BUBECK

plays BN15-400X



GUITAR LOUDSPEAKER SPECIFICATIONS



	12"							
	RUBY	BLUE	CREAM	GOLD	G12M GREENBACK	G12H ANNIVERSARY	G12EVH SIGNATURE	G12M-65 CREAMBACK
GENERAL SPECIFICATIONS								
Nominal Diameter	12", 305mm	12", 305mm	12", 305mm	12", 305mm	12", 305mm	12", 305mm	12", 305mm	12", 305mm
Power Rating	35W	15W	90W	50W	25W	30W	20W	65W
Nominal Impedance	8Ω & 16Ω	8Ω & 15Ω	8Ω & 16Ω	8Ω & 15Ω	8Ω & 16Ω	8Ω & 16Ω	8Ω & 15Ω	8Ω & 16Ω
Sensitivity	100dB	100dB	100dB	100dB	98dB	100dB	96dB	97dB
Voice Coil Diameter	1.75", 44.5mm	1.75", 44.5mm	1.75", 44.5mm	1.75", 44.5mm	1.75", 44.5mm	1.75", 44.5mm	1.75", 44.5mm	1.75", 44.5mm
Magnet Type	Alnico	Alnico	Alnico	Alnico	Ceramic	Ceramic	Ceramic	Ceramic
Magnet Weight	n/a	n/a	n/a	n/a	35oz, 0.99kg	50oz, 1.42kg	35oz, 0.99kg	35oz, 0.99kg
Frequency Range	75-5000Hz	75-5000Hz	75-5000Hz	75-5000Hz	75-5000Hz	75-5000Hz	75-5000Hz	75-5000Hz
Resonance Frequency, Fs	75Hz	75Hz	75Hz	75Hz	75Hz	85Hz	75Hz	75Hz
DC Resistance, Re	6.7Ω & 13.1Ω	6.4Ω & 11.8Ω	6.7Ω & 13.1Ω	6.4Ω & 11.8Ω	6.7Ω & 13.1Ω	6.7Ω & 13.1Ω	6.57Ω & 12.13Ω	6.7Ω & 13.1Ω
MOUNTING INFORMATION								
Cut-out Diameter	11.1", 283mm	11.1", 283mm	11.1", 283mm	11.1", 283mm	11.1", 283mm	11.1", 283mm	11.1", 283mm	11.1", 283mm
Diameter	12.2", 309mm	12.2", 309mm	12.2", 309mm	12.2", 309mm	12.2", 309mm	12.2", 309mm	12.2", 309mm	12.2", 309mm
Magnet Structure Diameter	5.0", 128mm	5.0", 128mm	5.0", 128mm	5.0", 128mm	5.9", 150mm	6.1", 156mm	5.9", 150mm	5.9", 150mm
Mounting Hole Dimensions	0.31", 7.9mm Ø	0.31", 7.9mm Ø	0.31", 7.9mm Ø	0.31", 7.9mm Ø	0.31", 7.9mm Ø	0.31", 7.9mm Ø	0.31", 7.9mm Ø	0.31", 7.9mm Ø
Mounting Hole PCD	11.7", 297mm	11.7", 297mm	11.7", 297mm	11.7", 297mm	11.7", 297mm	11.7", 297mm	11.7", 297mm	11.7", 297mm
Number of Mounting Holes	8	4	8	4	4	4	4	8
Chassis Depth*	3.63", 92mm	3.63", 92mm	3.63", 92mm	3.63", 92mm	3.58", 91mm	3.79", 97mm	3.56", 91mm	3.56", 91mm
Magnet Depth	2.87", 73mm	2.87", 73mm	2.87", 73mm	2.87", 73mm	1.52", 39mm	1.51", 38mm	1.54", 39mm	1.54", 39mm
Overall Depth	6.5", 165mm	6.5", 165mm	6.5", 165mm	6.5", 165mm	5.1", 130mm	5.3", 135mm	5.1", 130mm	5.1", 130mm
Unit Weight	9.3lb, 4.2kg	9.3lb, 4.2kg	9.3lb, 4.2kg	9.3lb, 4.2kg	7.9lb, 3.6kg	10.4lb, 4.7kg	7.9lb, 3.6kg	7.9lb, 3.6kg

* Including gasket

GUITAR LOUDSPEAKER FREQUENCY RESPONSE

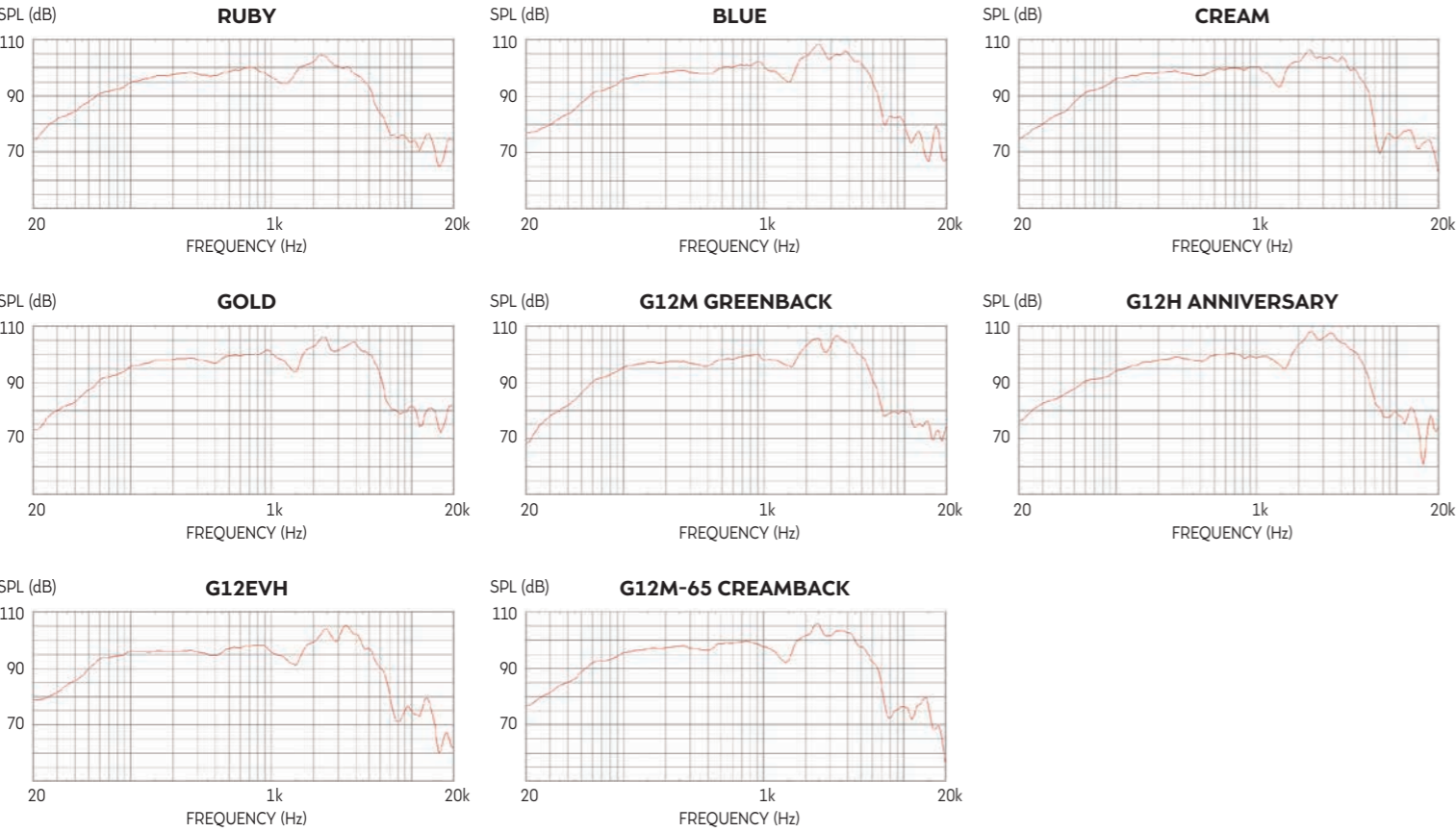

GUITAR LOUDSPEAKER SPECIFICATIONS



	12"							
	G12H-75 CREAMBACK	NEO CREAMBACK	VINTAGE 30	G12-65	CLASSIC LEAD 80	NEO COPPERBACK	G12T-75	G12K-100
GENERAL SPECIFICATIONS								
Nominal Diameter	12", 305mm	12", 305mm	12", 305mm	12", 305mm	12", 305mm	12", 305mm	12", 305mm	12", 305mm
Power Rating	75W	60W	60W	65W	80W	250W	75W	100W
Nominal Impedance	8Ω & 16Ω	8Ω & 16Ω	8Ω & 16Ω	8Ω & 15Ω	8Ω & 16Ω	4Ω, 8Ω & 16Ω	8Ω & 16Ω	8Ω
Sensitivity	100dB	97dB	100dB	97dB	99dB	100dB	97dB	99dB
Voice Coil Diameter	1.75", 44.5mm	1.75", 44.5mm	1.75", 44.5mm	1.75", 44.5mm	1.75", 44.5mm	2.5", 63mm	1.75", 44.5mm	1.75", 44.5mm
Magnet Type	Ceramic	Neodymium	Ceramic	Ceramic	Ceramic	Neodymium	Ceramic	Ceramic
Magnet Weight	50oz, 1.42kg	n/a	50oz, 1.42kg	35oz, 0.99kg	50oz, 1.42kg	50oz, 1.42kg	35oz, 0.99kg	50oz, 1.42kg
Frequency Range	70-5000Hz	75-5000Hz	70-5000Hz	80-5000Hz	80-5000Hz	70-5500Hz	80-5000Hz	80-5500Hz
Resonance Frequency, Fs	75Hz	75Hz	75Hz	85Hz	85Hz	55Hz	85Hz	85Hz
DC Resistance, Re	6.37Ω & 12.5Ω	6.6Ω & 13.1Ω	7.3Ω & 12.9Ω	6.9Ω & 11.8Ω	6.9Ω & 11.8Ω	3.5Ω, 7.2Ω & 13.9Ω	6.77Ω & 12.9Ω	7Ω
MOUNTING INFORMATION								
Cut-out Diameter	11.1", 283mm	11.1", 283mm	11.1", 283mm	11.1", 283mm	11.1", 283mm	11.1", 283mm	11.1", 283mm	11.1", 283mm
Diameter	12.2", 309mm	12.2", 309mm	12.2", 309mm	12.2", 309mm	12.2", 309mm	12.2", 309mm	12.2", 309mm	12.2", 309mm
Magnet Structure Diameter	6.6", 188mm	4.9", 124mm	6.1", 156mm	5.7", 145mm	6.1", 156mm	4.9", 125mm	5.7", 145mm	6.1", 156mm
Mounting Hole Dimensions	0.31", 7.9mm Ø	0.31", 7.9mm Ø	0.31", 7.9mm Ø	0.31", 7.9mm Ø	0.31", 7.9mm Ø	0.31", 7.9mm Ø	0.31", 7.9mm Ø	0.31", 7.9mm Ø
Mounting Hole PCD	11.7", 297mm	11.7", 297mm	11.7", 297mm	11.7", 297mm	11.7", 297mm	11.7", 297mm	11.7", 297mm	11.7", 297mm
Number of Mounting Holes	8	8	4	4	4	8	4	4
Chassis Depth*	3.67", 94mm	3.64", 93mm	3.79", 97mm	3.67", 94mm	3.79", 97mm	3.83", 97mm	3.70", 94mm	3.89", 99mm
Magnet Depth	1.73", 44mm	1.16", 30mm	1.51", 38mm	1.33", 34mm	1.51", 38mm	1.17", 30mm	1.30", 33mm	1.41", 36mm
Overall Depth	5.4", 138mm	4.8", 122mm	5.3", 135mm	5.0", 128mm	5.3", 135mm	5", 127mm	5.0", 127mm	5.3", 135mm
Unit Weight	10.4lb, 4.7kg	4.2lb, 1.9kg	10.4lb, 4.7kg	7.7lb, 3.5kg	10.4lb, 4.7kg	5lb, 2.3kg	7.7lb, 3.5kg	10.4lb, 4.7kg

GUITAR LOUDSPEAKER FREQUENCY RESPONSE

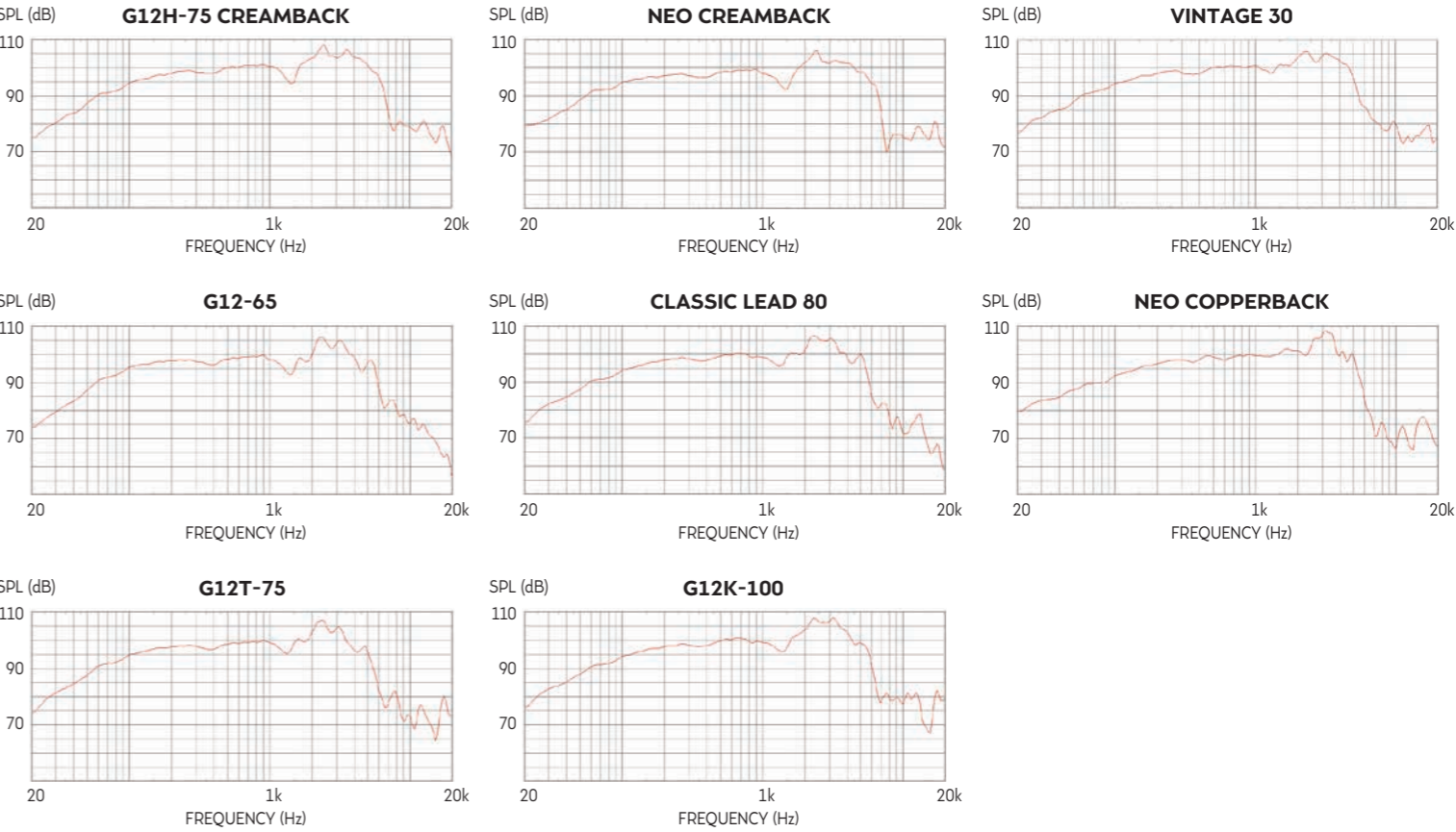

GUITAR LOUDSPEAKER SPECIFICATIONS



	12"							
	G12H-150 REDBACK	A-TYPE	V-TYPE	MIDNIGHT 60	G12T HOT 100	ROCKET 50	SEVENTY 80	F12-X200
GENERAL SPECIFICATIONS								
Nominal Diameter	12", 305mm	12", 305mm	12", 305mm	12", 305mm	12", 305mm	12", 305mm	12", 305mm	12", 305mm
Power Rating	150W	50W	70W	60W	100W	50W	80W	200W
Nominal Impedance	8Ω & 16Ω	8Ω & 16Ω	8Ω & 16Ω	8Ω & 16Ω	4Ω, 8Ω & 16Ω	8Ω	8Ω & 16Ω	8Ω
Sensitivity	100dB	98dB	98dB	96dB	97dB	95dB	98dB	97dB
Voice Coil Diameter	2", 50mm	1.75", 44.5mm	1.75", 44.5mm	1.75", 44.5mm	2", 50.8mm	1.5", 38.1mm	1.75", 44.5mm	2", 50.8mm
Magnet Type	Ceramic	Ceramic	Ceramic	Ceramic	Ceramic	Ceramic	Ceramic	Ceramic
Magnet Weight	50oz, 1.42kg	35oz, 0.99kg	31oz, 0.88kg	20oz, 0.6kg	35oz, 0.99kg	17oz, 0.48kg	31oz, 0.88kg	
Frequency Range	70-5000Hz	75-5000Hz	70-5000Hz	75-5000Hz	80-5000Hz	85-5000Hz	80-5000Hz	60-20000Hz
Resonance Frequency, Fs	75Hz	75Hz	75Hz	75Hz	86Hz	90Hz	85Hz	75Hz
DC Resistance, Re	6.45Ω & 12.54Ω	6.2Ω & 12.7Ω	7.3Ω & 12.9Ω	6.82Ω & 13.12Ω	3.4Ω,7.4Ω&14.83Ω	6.74Ω & 12.44Ω	6.1Ω & 10.41Ω	5.91Ω
MOUNTING INFORMATION								
Cut-out Diameter	11.1", 283mm	11.1", 283mm	11.1", 283mm	11.1", 283mm	11.1", 283mm	11.1", 283mm	11.1", 283mm	11.1", 283mm
Diameter	12.2", 309mm	12.2", 309mm	12.2", 309mm	12.2", 309mm	12.2", 309mm	12.2", 309mm	12.2", 309mm	12.2", 309mm
Magnet Structure Diameter	6.6", 168mm	5.7", 145mm	5.3", 134mm	4.5", 115mm	5.8", 148mm	3.9", 100mm	5.3", 134mm	6.7", 170mm
Mounting Hole Dimensions	0.31", 7.9mm Ø	0.31", 7.9mm Ø	0.31", 7.9mm Ø	0.31", 7.9mm Ø	0.31", 7.9mm Ø	0.31", 7.9mm Ø	0.31", 7.9mm Ø	0.31", 7.9mm Ø
Mounting Hole PCD	11.7", 297mm	11.7", 297mm	11.7", 297mm	11.7", 297mm	11.7", 297mm	11.7", 297mm	11.7", 297mm	11.7", 297mm
Number of Mounting Holes	8	8	8	8	4	4	4	8
Chassis Depth*	3.71", 95mm	3.70", 94	3.70", 94mm	3.68", 94mm	3.60", 91mm	3.72", 95mm	3.48", 88mm	3.86", 98mm
Magnet Depth	1.69", 43mm	1.30", 33mm	1.18", 30mm	1.02", 26mm	1.30", 33mm	1.08", 27mm	1.22", 31mm	2.64", 67mm
Overall Depth	5.4", 138mm	5.0", 127mm	4.88", 124mm	4.7", 120mm	4.9", 124mm	4.8", 122mm	4.7", 119mm	6.5", 165mm
Unit Weight	10.4lb, 4.7kg	7.7lb, 3.5kg	7.2lb, 3.3kg	5.5lb, 2.5kg	7.1lb, 3.2kg	4.4lb, 2.0kg	6.8lb, 3.1kg	9.1lb, 4.1kg

* Including gasket

GUITAR LOUDSPEAKER FREQUENCY RESPONSE

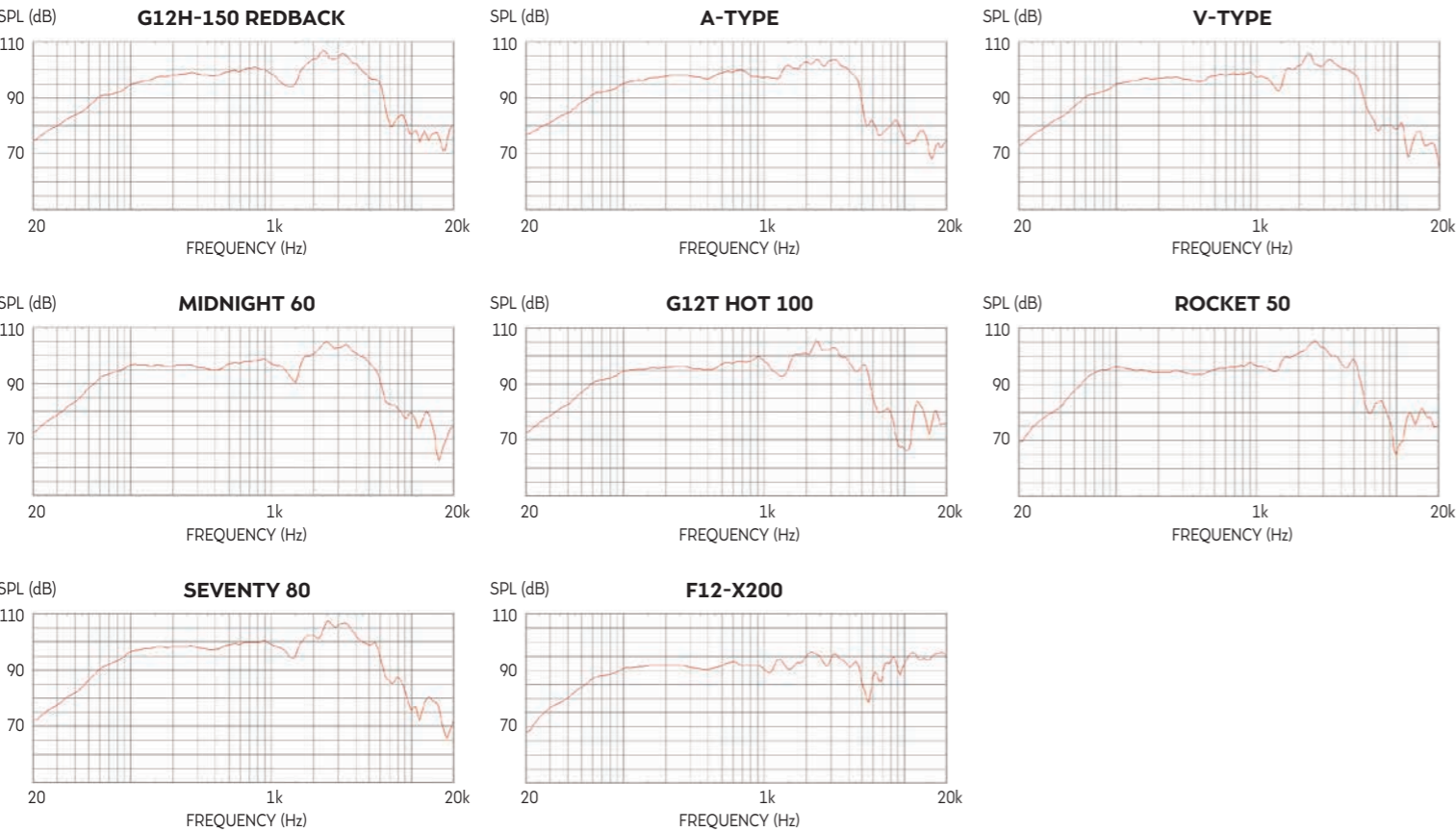

GUITAR LOUDSPEAKER SPECIFICATIONS



	8"	10"						
	EIGHT 15	G10 GOLD	G10 GREENBACK	G10 CREAMBACK	G10 VINTAGE	VT JUNIOR	TEN 30	G15V-100 FULLBACK
GENERAL SPECIFICATIONS								
Nominal Diameter	8", 203mm	10", 254mm	10", 254mm	10", 254mm	10", 254mm	10", 254mm	10", 254mm	15", 381mm
Power Rating	20W	40W	30W	45W	60W	50W	30W	100W
Nominal Impedance	4Ω, 8Ω & 16Ω	8Ω & 15Ω	8Ω & 16Ω	8Ω & 16Ω	8Ω & 16Ω	8Ω & 16Ω	8Ω & 16Ω	8Ω & 16Ω
Sensitivity	95dB	98dB	95dB	96dB	97dB	95dB	95dB	99dB
Voice Coil Diameter	1", 25mm	1.75", 44.5mm	1.75", 44.5mm	1.75", 44.5mm	1.75", 44.5mm	1.75", 44.5mm	1.25", 31.25mm	2", 50mm
Magnet Type	Ceramic	Alnico	Ceramic	Ceramic	Ceramic	Ceramic	Ceramic	Ceramic
Magnet Weight	13oz, 0.37kg	n/a	20oz, 0.56kg	20oz, 0.56kg	31oz, 0.88kg	20oz, 0.56kg	16oz, 0.41kg	50oz, 1.42kg
Frequency Range	100-6000Hz	80-6000Hz	95-5500Hz	95-5500Hz	100-5500Hz	90-5500Hz	85-500Hz	65-4000Hz
Resonance Frequency, Fs	120Hz	80Hz	98Hz	98Hz	115Hz	90Hz	93.9Hz	85Hz
DC Resistance, Re	2.63Ω, 6.55Ω & 12.88Ω	6.66Ω & 13.56Ω	6.4Ω & 12.05Ω	6.4Ω & 12.05Ω	7.47Ω & 12.33Ω	6.78Ω & 12.92Ω	6Ω & 11.07Ω	6.4Ω
MOUNTING INFORMATION								
Cut-out Diameter	7.2", 183mm	9.0", 229mm	9.0", 229mm	9.0", 229mm	9.0", 229mm	9.0", 229mm	9.0", 229mm	13.8", 351mm
Diameter	8.1", 205mm	10.1", 256mm	10.1", 256mm	10.1", 256mm	10.1", 256mm	10.1", 256mm	10.1", 256mm	15.2", 385mm
Magnet Structure Diameter	3.3", 85mm	4.7", 119mm	4.9", 124mm	4.9", 124mm	5.3", 134mm	4.5", 115mm	3.8", 96mm	6.1", 156mm
Mounting Hole Dimensions	0.19x0.31", 5x8mm	0.2x0.3", 6x8mm	0.2x0.3", 6x8mm	0.2x0.3", 6x8mm	0.2x0.3", 6x8mm	0.2x0.3", 6x8mm	0.2x0.3", 6x8mm	0.36x0.24", 9.2x7.9mm
Mounting Hole PCD	7.7", 195mm	9.6", 244mm	9.6", 244mm	9.6", 244mm	9.6", 244mm	9.6", 244mm	9.6", 244mm	14.6", 369mm
Number of Mounting Holes	4	8	8	8	4	8	8	8
Chassis Depth*	2.28", 58mm	2.87", 73	2.83", 72mm	2.86", 73mm	2.88", 73mm	2.64", 67mm	2.64", 67mm	4.58", 117mm
Magnet Depth	1.02", 26mm	2.43", 62mm	1.17", 30mm	1.14", 29mm	1.22", 31mm	1.02", 26mm	1.16", 30mm	1.42", 36mm
Overall Depth	3.30", 84mm	5.3", 135mm	4.0", 102mm	4.0", 102mm	4.1", 104mm	3.66", 93mm	3.8", 96mm	6.0", 153mm
Unit Weight	2.2lb, 1kg	6.0lb, 2.7kg	3.6lb, 1.7kg	3.6lb, 1.7kg	5.3lb, 2.4kg	3.5lb, 1.6kg	3.1lb, 1.4kg	10.6lb, 4.8kg

GUITAR LOUDSPEAKER FREQUENCY RESPONSE

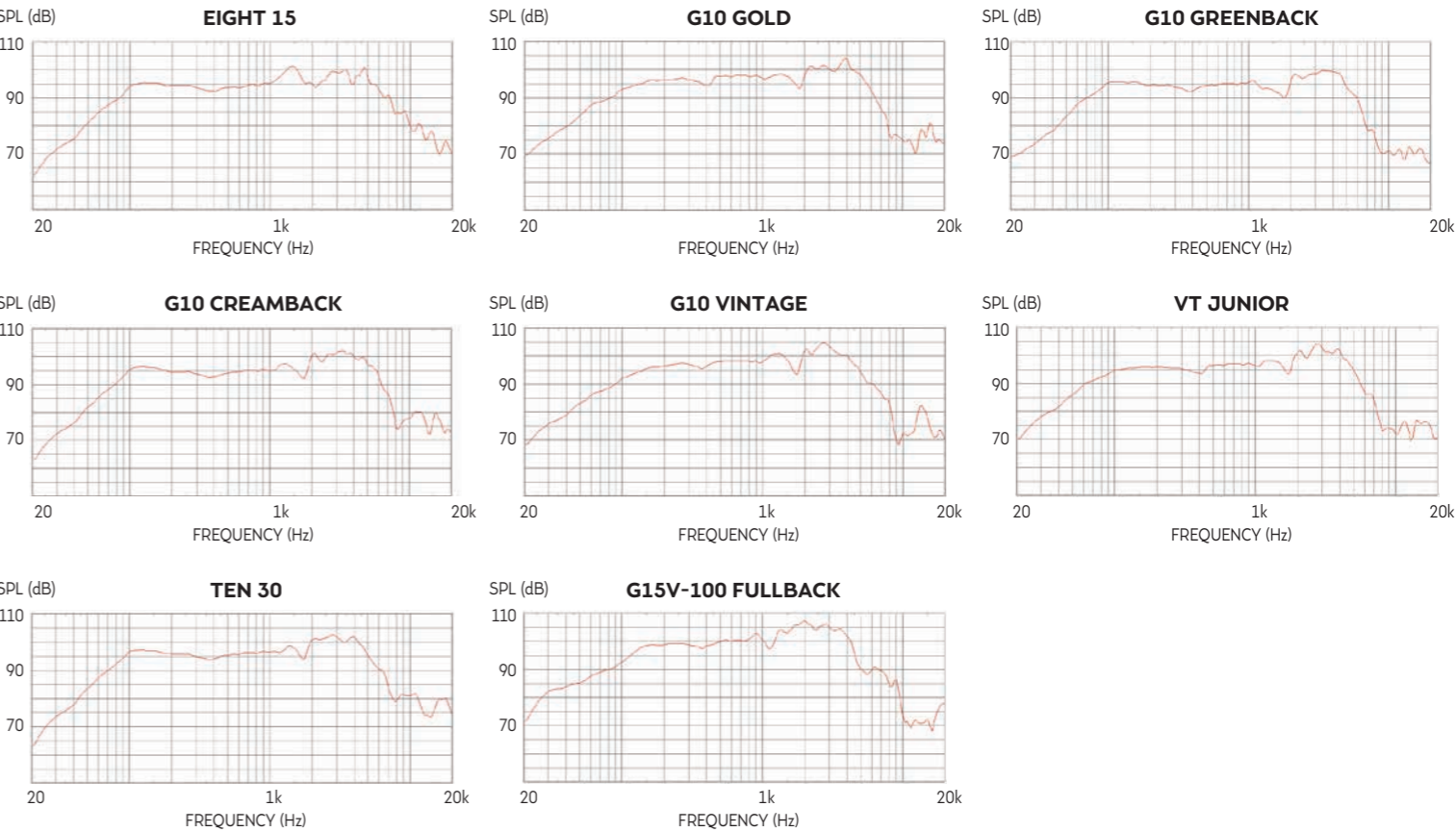

BASS LOUDSPEAKER SPECIFICATIONS



	10"				12"	
	PULSE 10	BL10-100X	BN10-200X	BN10-300X	PULSE 12	BN12-300S (4)
GENERAL SPECIFICATIONS						
Nominal Diameter	10", 254mm	10", 254mm	10", 254mm	10", 254mm	12", 304.8mm	12", 304.8mm
Power Rating	200W	100W	200W	300W	200W	300W
Nominal Impedance	8Ω	8Ω	8Ω	4Ω	8Ω	4Ω
Sensitivity	94dB	94dB	96dB	96dB	94dB	99dB
Magnet Type	Ferrite	Ferrite	Neodymium	Neodymium	Ferrite	Neodymium
Voice Coil Diameter	2", 50.8mm	1.5", 38.1mm	2", 50.8mm	2.5", 63.5mm	2", 50.8mm	2.5", 63.5mm
Coil Material	Copper	Copper	Copper	Copper	Copper	Copper
Cone Material	Kevlar loaded paper	Kevlar loaded paper	Kevlar loaded paper	Kevlar loaded paper	Kevlar loaded paper	Kevlar loaded paper
Former Material	Polyimide	Polyimide	Polyimide	Polyimide	Polyimide	Polyimide
Surround Material	Cloth-sealed	Cloth-sealed	Cloth-sealed	Cloth-sealed	Cloth-sealed	Cloth-sealed
Frequency Range	45-3500Hz	45-3500Hz	45-3500Hz	40-2500Hz	45-3500Hz	50-4000Hz
Xmax	0.15", 4mm	0.14", 3.5mm	0.15", 4mm	0.15", 4mm	0.15", 4mm	0.098", 2.5mm
Gap Depth	0.31", 8mm	0.24", 6mm	0.31", 8mm	0.31", 8mm	0.31", 8mm	0.31", 8mm
Voice Coil Winding Width	0.62", 16mm	0.51", 13mm	0.62", 16mm	0.62", 16mm	0.62", 16mm	0.51", 13mm
SMALL SIGNAL PARAMETERS						
D	0.21m, 8.3in	0.21m, 8.3mm	0.21m, 8.3mm	0.21m, 8.3mm	0.26m, 10.2in	0.26m, 10.2in
Fs	68Hz	74.4Hz	50.7Hz	64Hz	45Hz	51.4Hz
Mms	32.9g, 1.16oz	28.7g, 1.01oz	32.21g, 1.14oz	35.81g, 1.26oz	47.6g, 1.68oz	48.31g, 1.7oz
Qms	2.54	2.88	3.67	3.33	2.74	3.64
Qes	0.53	0.653	0.297	0.5	0.49	0.395
Qts	0.44	0.532	0.274	0.43	0.42	0.356
Re	6.0Ω	6.6Ω	5.9Ω	3.0Ω	5.8Ω	2.7Ω
Vas	25.1lt, 0.91cu.ft.	25.1lt, 0.89cu.ft.	52lt, 1.84cu.ft.	29.2lt, 1.03cu.ft.	104.6lt, 3.7cu.ft.	80.6lt, 2.85cu.ft.
Bl	12.88Tm	14.29Tm	11.98Tm	9.39Tm	12.71Tm	10.37Tm
Cms	0.15mm/N	0.148mm/N	0.306mm/N	0.17mm/N	0.26mm/N	0.198mm/N
Rms	5.79kg/s	4.88kg/s	2.79kg/s	4.34kg/s	4.92kg/s	4.296kg/s
Le (at 1kHz)	0.92mH	0.73mH	0.63mH	0.32mH	1.0mH	0.26mH
MOUNTING INFORMATION						
Cut-out Diameter	9", 229mm	9", 229mm	9", 229mm	9", 229mm	11.1", 283mm	11.1", 283mm
Diameter	10.1", 256mm	10.1", 256mm	10.1", 256mm	10.1", 256mm	12.2", 309mm	12.2", 309mm
Mounting Hole Dimensions	0.2x0.3", 6x8mm	0.2x0.3", 6x8mm	0.2x0.3", 6x8mm	0.2x0.3", 6x8mm	0.31", 7.9mm Ø	0.31", 7.9mm Ø
Mounting Hole PCD	9.6", 245mm	9.6", 245mm	9.6", 245mm	9.6", 245mm	11.7", 297mm	11.7", 297mm
Number of Mounting Holes	4	4	8	4	4	4
Chassis Depth*	3.06", 76mm	2.98", 76mm	3.02", 77mm	2.96", 76mm	3.76", 96mm	3.76", 96mm
Magnet Depth	1.34", 34mm	1.22", 31mm	1.38", 35mm	1.44", 37mm	1.34", 34mm	1.44", 37mm
Overall Depth	4.4", 110mm	4.2", 107mm	4.4", 112mm	4.4", 112mm	5.1", 130mm	5.2", 132mm
Unit Weight	6.6lb, 3kg	5.3lb, 2.4kg	3.3lb, 1.5kg	3.5lb, 1.6kg	7lb, 3.2kg	4.4lb, 2.0kg
* Including gasket						

BASS LOUDSPEAKER FREQUENCY RESPONSE

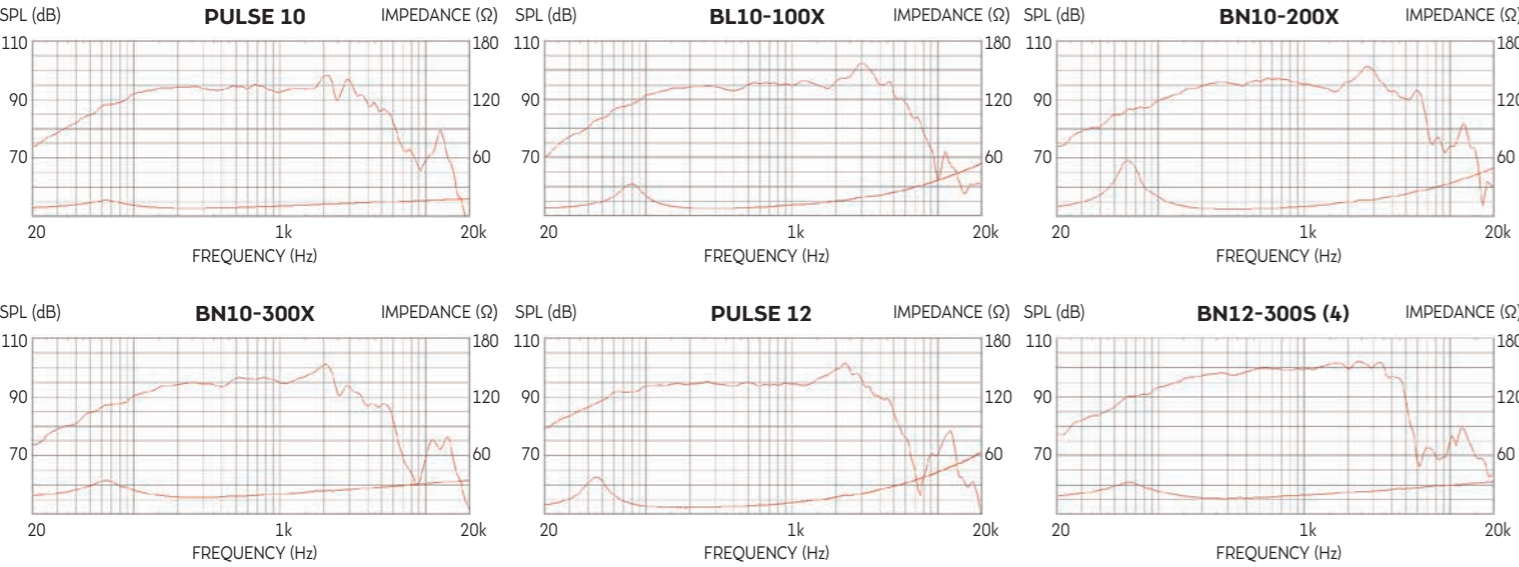

BASS LOUDSPEAKER SPECIFICATIONS



	15"				
	BN12-300S (8)	PULSE 15	BL15-300X (4)	BN15-300X	BN15-400X
GENERAL SPECIFICATIONS					
Nominal Diameter	12", 304.8mm	15", 381mm	15", 381mm	15", 381mm	15", 381mm
Power Rating	300W	400W	300W	300W	400W
Nominal Impedance	8Ω	8Ω	4Ω	8Ω	8Ω
Sensitivity	99dB	96dB	96dB	96dB	95dB
Magnet Type	Neodymium	Ferrite	Ferrite	Neodymium	Neodymium
Voice Coil Diameter	2.5", 63.5mm	3", 76.2mm	2.5", 63.5mm	2.5", 63.5mm	3", 76.2mm
Coil Material	Copper	Copper	Copper	Copper	Copper
Cone Material	Kevlar loaded paper	Kevlar loaded paper	Kevlar loaded paper	Kevlar loaded paper	Kevlar loaded paper
Former Material	Polyimide	Polyimide	Polyimide	Polyimide	Polyimide
Surround Material	Cloth-sealed	Cloth-sealed	Cloth-sealed	Cloth-sealed	Cloth-sealed
Frequency Range	50-4000Hz	40-3500Hz	42-3500Hz	42-3500Hz	38-3000Hz
Xmax	0.098", 2.5mm	0.18", 4.75mm	0.16", 4.25mm	0.15", 4mm	0.15", 4mm
Gap Depth	0.31", 8mm	0.31", 8mm	0.31", 8mm	0.31", 8mm	0.39", 10mm
Voice Coil Winding Width	0.51", 13mm	0.68", 17.5mm	0.64", 16.5mm	0.62", 16mm	0.70", 18mm
SMALL SIGNAL PARAMETERS					
D	0.26m, 10.2in	0.33m, 12.99in	0.33m, 12.99in	0.33m, 12.99in	0.33m, 12.99in
Fs	62.1Hz	35.1Hz	48.1Hz	57.8Hz	35.1Hz
Mms	52.38g, 1.85oz	83.32g, 2.94oz	83.39g, 2.91oz	84.24g, 2.97oz	83.98g, 2.96oz
Qms	2.74	4.75	2.99	4.49	5.07
Qes	0.361	0.474	1.004	1.1	0.588
Qts	0.319	0.431	0.751	0.9	0.527
Re	5.1Ω	5.7Ω	3.1Ω	3.1Ω	5.2Ω
Vas	50lt, 1.77cu.ft.	246.7lt, 8.7cu.ft.	137.7lt, 4.86cu.ft.	98.7lt, 3.48cu.ft.	253lt, 8.93cu.ft.
Bl	17.02Tm	15.06Tm	8.83Tm	9.13Tm	12.9Tm
Cms	0.125mm/N	0.24mm/N	0.133mm/N	0.09mm/N	0.244mm/N
Rms	7.455kg/s	3.93kg/s	8.327kg/s	6.42kg/s	3.655kg/s
Le (at 1kHz)	0.51mH	0.87mH	0.45mH	0.39mH	1.08mH
MOUNTING INFORMATION					
Cut-out Diameter	11.1", 283mm	13.8", 351mm	13.8", 351mm	13.8", 351mm	13.8", 351mm
Diameter	12.2", 309mm	15.2", 385mm	15.2", 385mm	15.2", 385mm	15.2", 385mm
Mounting Hole Dimensions	0.31", 7.9mm Ø	0.36x0.24", 9.2x6.2mm	0.36x0.24", 9.2x6.2mm	0.36x0.24", 9.2x6.2mm	0.36x0.24", 9.2x6.2mm
Mounting Hole PCD	11.7", 297mm	14.5", 369mm	14.5", 369mm	14.5", 369mm	14.5", 369mm
Number of Mounting Holes	4	8	8	8	8
Chassis Depth*	3.76", 96mm	4.61", 117mm	4.67", 116mm	4.56", 116mm	4.56", 116mm
Magnet Depth	1.44", 37mm	1.79", 46mm	1.80", 46mm	1.44", 37mm	1.56", 40mm
Overall Depth	5.2", 132mm	6.4", 162mm	6.47", 162mm	6", 152mm	6.12", 155mm
Unit Weight	4.4lb, 2.0kg	10.8lb, 4.9kg	10.6lb, 4.8kg	5.1lb, 2.3kg	5.7lb, 2.6kg

BASS LOUDSPEAKER FREQUENCY RESPONSE

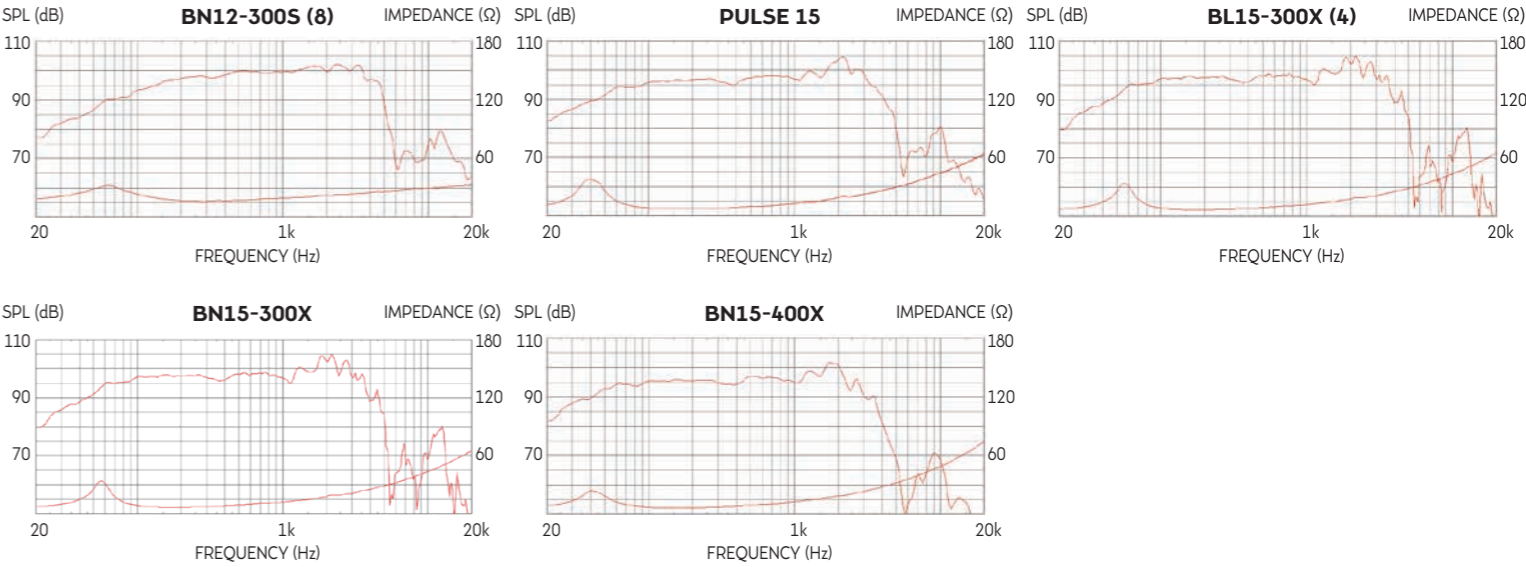

CHASSIS DIMENSIONS



For illustrative purposes only. Refer to Mounting Information for complete, individual loudspeaker dimensions.
Measurements shown in mm, to convert to inches, divide by 25.

8" LOUDSPEAKERS

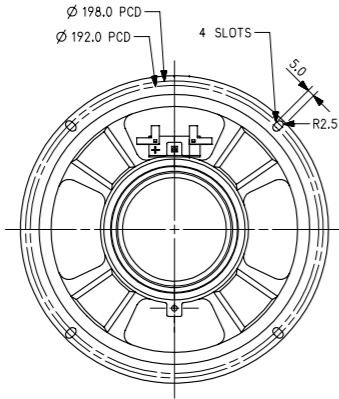
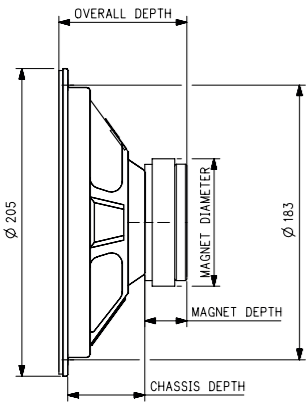

CONNECTOR TAGS

Connector tag dimensions are common to all loudspeakers

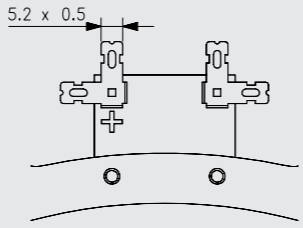

10" LOUDSPEAKERS

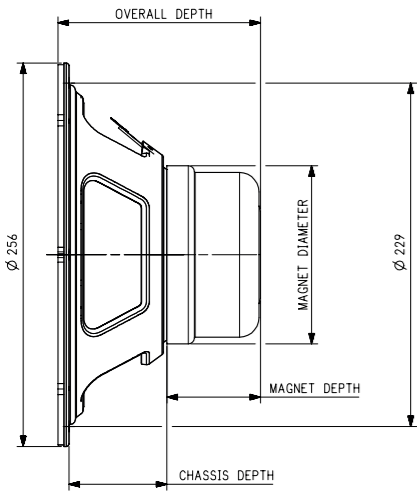

ALNICO MAGNET

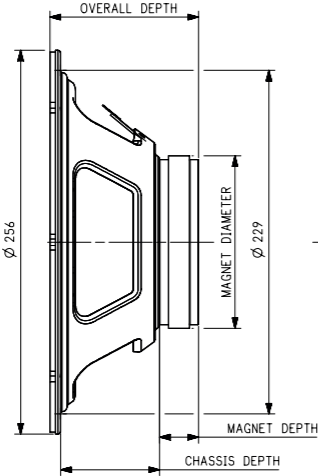

FERRITE/NEO MAGNET

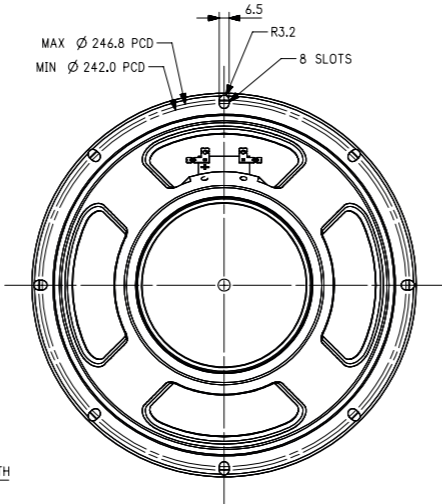

CHASSIS DIMENSIONS



For illustrative purposes only. Refer to Mounting Information for complete, individual loudspeaker dimensions.
Measurements shown in mm, to convert to inches, divide by 25.

12" LOUDSPEAKERS

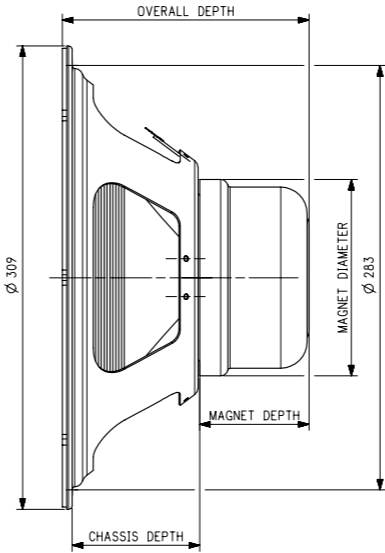

ALNICO MAGNET

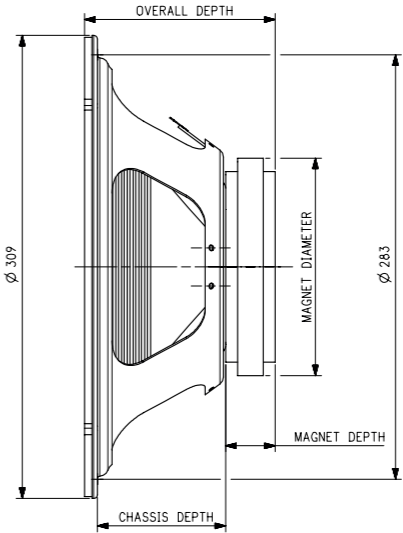

FERRITE/NEO MAGNET

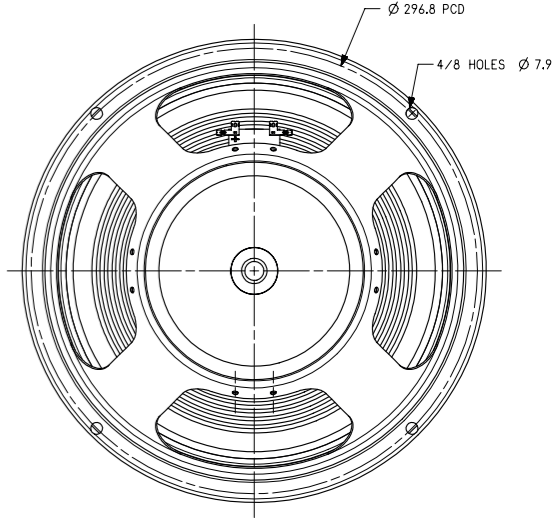

15" LOUDSPEAKERS

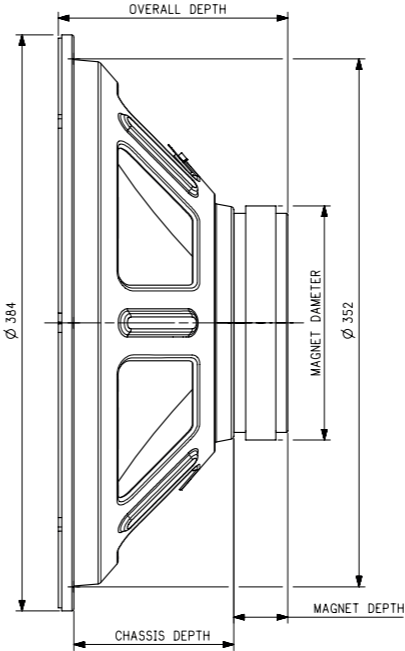

FERRITE/NEO MAGNET

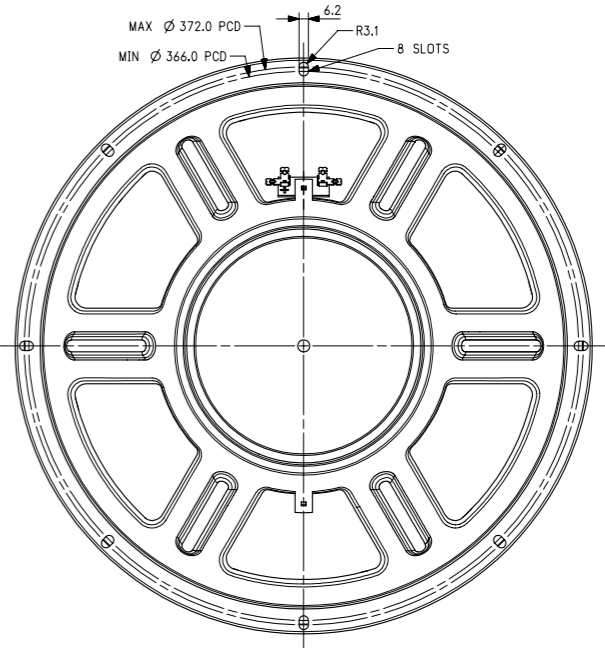

BUILD YOUR OWN 1X12 CABINET FOR THE F12-X200

FULL RANGE, LIVE RESPONSE LOUDSPEAKER

The world's first dedicated guitar loudspeaker for use with amp modellers and IRs delivers great guitar tone in a conventional open or closed back guitar cabinet. To get the most from the speaker's full range capability, we recommend loading it into a bass reflex cabinet. Here's one you can build yourself.

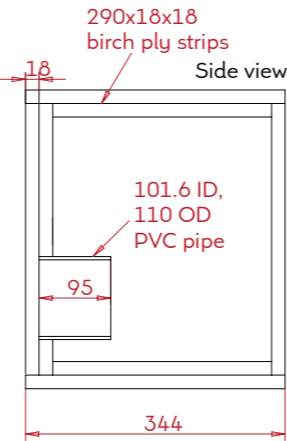
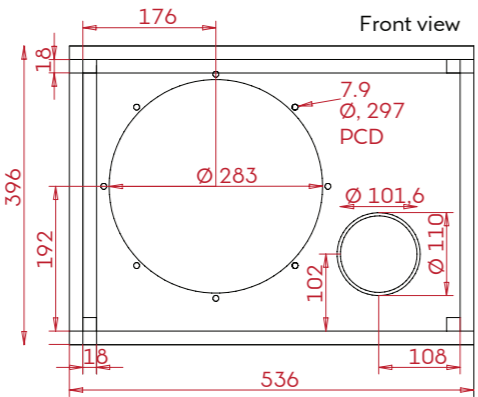
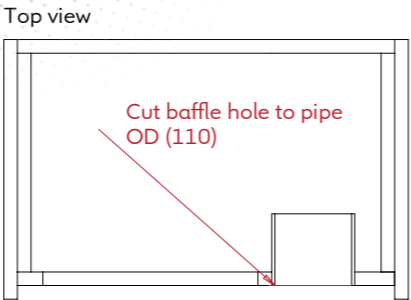

F12-X200 Small Signal Parameters

D	0.26m/10.24in
Fs	69.8Hz
Mms	50.19g/1.77oz
Qms	12.007
Qes	0.831
Qts	0.777
Re	5.91Ω
Vas	47.3l/16.7 cu. ft.
Bl	12.52Tm
Cms	0.103mm/N
Rms	1.834kg/s

Units shown in millimetres. To convert to inches, divide figure by 25.



PARTNERS IN TONE
LZZY HALE
plays Vintage 30

CELESTION



celestion.com

Please note that Celestion adopt a progressive policy and we reserve the right to alter drive unit specifications and/or appearance without prior notice. E&OE
LIT0711/1219